

Assembly instructions

IN051 Promotion Table Trapeze



The content of the package:

- A. Textile bag: 1 pc.
- B. Central body: 1 pc.
- C. Countertop: 2 pcs. and shelf: 1 pc.
- D. Header: 1 buc.
- E. Cylindrical rod: 4 pcs.

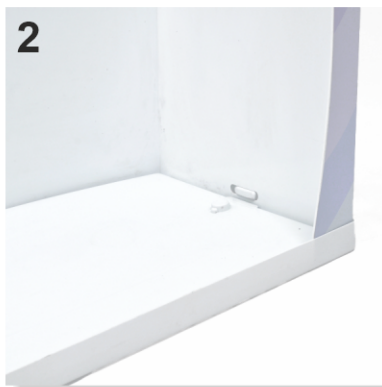

1. Take the lower countertop - the one without perforations - and place it on the floor.
2. Take the central body B and bend each crease to 90 degrees. Insert the central body into the perimeter groove on the lower countertop starting from the back as in the adjacent image. On the sides of the countertop there are two protrusions that will go into the related cutouts in the central body. Make sure the image on the center body is oriented correctly.
3. The introduction of the central body continues along the entire perimeter of the countertop as in image no. 3.
4. Take the upper countertop (the one with two perforations) and position it above the central body making sure that it enters the perimeter groove of the countertop.
5. Make sure the two protrusions fit into the corresponding cutouts in the central body.
6. The assembly thus mounted will be compact and stable.

The pictures are for presentation only; your product might be slightly different!

Assembly instructions

IN051 Promotion Table Trapeze

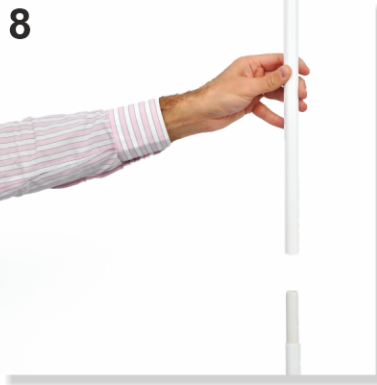

7. Take the shelf C (the top with several striations on the surface) and position it inside the central body, in the middle, hooking it into the tabs on it. In the situation where the tabs are positioned in reverse and the shelf cannot be hung, the central body will be reassembled in the correct position.

8. Join the four cylindrical rods E, two by two, to obtain two longer rods.

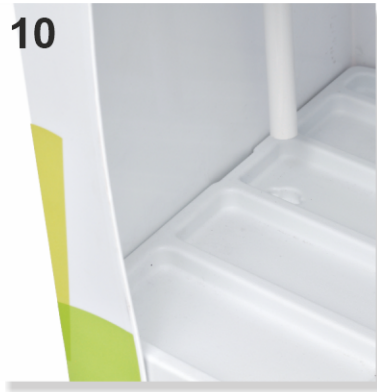

9-10. Insert the two rods thus formed through the upper countertop to the hole in the shelf, as in the adjacent image.



11. Mount the header D in the upper part of the two rods by joining the rods, as in the adjacent image.

12. Now the Promotion Table Trapez stand is mounted.